

ALL TEST® Multi-Drug Rapid Test Cup

User Instruction

【INTENDED USE】

AllTest Multi-Drug Rapid Test Cup tests are competitive binding, lateral flow immunochromatographic assays for qualitative and simultaneous detection of Amphetamine, Buprenorphine, Secobarbital, Benzodiazepines, Cocaine, 2-ethylidene-1,5-dimethyl-3,3-diphenylpyrrolidine, Methamphetamine, Methylenedioxymethamphetamine, Morphine, Methadone, Oxycodone, Phencyclidine, Nortriptyline, Marijuana, Tramadol, Propoxyphene, Fentanyl and 6-monoacetylmorphine in human urine at the cutoff concentrations of:

Drug (Identifier)	Cut-off level
Amphetamine (AMP)	500 or 1000 ng/mL
Buprenorphine (BUP)	10 ng/mL
Secobarbital (BAR)	300 ng/mL
Benzodiazepines (BZO)	300 ng/mL
Cocaine (COC)	150 or 300 ng/mL
2-ethylidene-1,5-dimethyl-3,3-diphenylpyrrolidine (EDDP)	300 ng/mL
Methamphetamine (MET)	500 or 1000 ng/mL
Methylenedioxymethamphetamine (MDMA)	500 ng/mL
Morphine (MOP/OPI)	300 or 2000 ng/mL
Methadone (MTD)	300 ng/mL
Oxycodone (OXY)	100 ng/mL
Phencyclidine (PCP)	25 ng/mL
Nortriptyline (TCA)	1000 ng/mL
Marijuana (THC)	50 ng/mL
Tramadol (TRA)	100 ng/mL
Propoxyphene (PPX)	300 ng/mL
Fentanyl (FYL)	1 ng/mL
6-monoacetylmorphine (6-MAM)	10 ng/mL

AllTest Multi-Drug Rapid Test Cup can be a single drug test cup or used for any combinations of the above listed analytes. It is for *in vitro* diagnostic use only. It is intended for OTC use.

The tests may yield positive results for the prescription drugs when taken at or above prescribed doses. It is not intended to distinguish between prescription use or abuse of these drugs. Clinical consideration and professional judgment should be applied to any drug of abuse test result, particularly in evaluating a preliminary positive result. The tests provide only preliminary results. To obtain a confirmed analytical result, a more specific alternate chemical method must be used. GC/MS or LC/MS is the recommended confirmatory method.

【WARNING】

- Read the entire user Instructions prior to performing test.
- For *in vitro* diagnostic use only.
- For external use only.
- Do not use the test after expiration date printed on the package.
- Do not use the test if its foil pouch is torn or damaged.
- For single use. Discard after first use
- The test device should remain in the sealed pouch until use.
- Contaminated or tainted urine sample may give false results.
- Keep out of reach of children.
- By itself, this test will not confirm if someone used a drug of abuse. These types of tests may incorrectly detect the presence of a drug of abuse when the person has consumed certain foods, medicines, diet plan drugs, or nutritional supplements. These are just some examples of the types of things that can cause a false result and there may be others as well. In order to show if someone used a drug of abuse, you will need to send the urine sample to a laboratory to have a second test, called a confirmation test, performed. The cost of the additional testing is not included in the purchase price of this screening test kit.

【ITEMS PROVIDED】

- Test cup
- User Instruction

【ITEMS REQUIRED BUT NOT PROVIDED】

- Watch, clock or timer

【STORAGE AND STABILITY】

Store as packaged in the sealed pouch at 35.6-86°F (2-30°C) up to the date of expiration. **Keep away from direct sunlight, moisture and heat. DO NOT FREEZE.**

【TESTING】

Allow the test to reach room temperature before testing.

Step 1: Getting Ready

- Remove the cup from the sealed pouch and use it immediately.
- Open the cap and collect urine in the cup, urine specimen must exceed the minimum urine level line.
- Close the cap tightly.

Step 2: Peel off the label

- Peels off the label on the cup body to view the test result window.

Step 3: Read Results

- Read the test results at **5 minutes**, do not read them after 10 minutes.

TEST PROCEDURE Cup

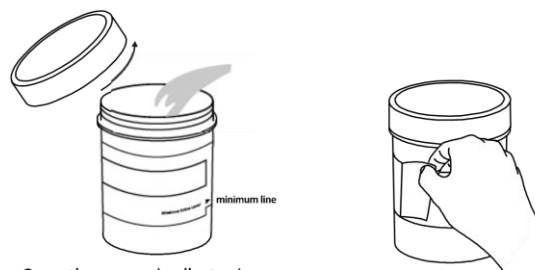

- Open the cap and collect urine.
 - Urine volume must exceed the minimum line.
 - Close the cap tightly.
- Peel off the label to view results

1

2

Reading Result at 5 minutes.

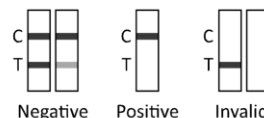

3

【READ RESULTS】

Each strip only contain 1 drug test, drug name was shown on the top of the strip, the C line(C) region shows validity of a test result and the T line(T) region shows result of the test.

Each test strip and test area should be looked at individually. Do not compare lines between test strips or different areas. Also, do not compare the color or darkness of the lines, or the rate at which the lines appear.

	NEGATIVE: Two colored lines appear on the test strip. One line appears next to the letter 'C' and the other line appears next to the letter 'T', meaning a NEGATIVE RESULT for that drug.
	POSITIVE: Only one colored line appears next to the letter 'C'. No colored line appears next to the letter 'T', meaning a Preliminary Positive Result for that drug.
	INVALID: Control line fails to appear.

IMPORTANT: The result you obtained is called preliminary for a reason. The sample must be tested by laboratory in order to confirm the result.

Detection Items, Levels and Approximate Detection Times

Drug Name (Abbreviation)	Detectable Level (ng/mL)	Minimum Detection Time *	Maximum Detection Time *
Amphetamine (AMP)	500/1000	3-6 hours	2-4 days
Secobarbital (BAR)	300	4 hours	7 days
Benzodiazepines (BZO)	300	4-6 hours	2-7 days
Buprenorphine (BUP)	10	2-4 hours	3 days
Cocaine (COC)	150/300	1-4 hours	2-3 days
Marijuana (THC)	50	2 hours	Up to 30 days
Methadone (MTD)	300	12 hours	48 hours
Methamphetamine (MET)	500/1000	2-4 hours	3-5 days
Methylenedioxymethamphetamine (MDMA)	500	1-3 hours	1-4 days
Morphine (MOP)	300	2-4 hours	1-3 days
Morphine (MOP2000)	2000	2-4 hours	1-3 days
Phencyclidine (PCP)	25	4-6 hours	7-14 days
Nortriptyline (TCA)	1,000	2-4 hours	2-3 days
Oxycodone (OXY)	100	2-4 hours	48 hours
2-ethylidene-1,5-dimethyl-3,3-diphenylpyrrolidine (EDDP)	300	12 hours	4-5 days
Tramadol (TRA)	100	1-3 hours	1-4 days
Propoxyphene (PPX)	300	1-3 hours	1-2 days
Fentanyl (FYL)	1	2-3 hours	1-3 days
6-monoacetylmorphine (6-MAM)	10	1-2 hours	2-5 days

* NOTE: The times are only estimates.

【Q&A】

1. How do I know if the Test worked well?

When the control line(C) appears, it means that the test unit is working well.

2. How soon can I read my results?

You can read your results after 5 minutes as long as a red line or pink colored line has appeared next to the Control region(C), do not read results after 10 minutes.

3. When is the best time to run the test?

You can run the test at any time of the day.

4. How to read the test if the color and the intensity of the lines are different?

The color and intensity of the lines have no importance for result interpretation. The test should be considered as negative whatever the color intensity of the test line (T) is.

5. What is A False Positive Test?

A false positive test result means the drug is not present but shows detected by the device. The most common causes of a false positive test are cross reactants.

6. What is A False Negative Test?

A false negative test means the drug is present but is not detected by the device. If the

sample is diluted, or the sample is contaminated that may cause a false negative result.

【LIMITATIONS】

1. The Test is for use with human urine only.
2. The Test provides only a preliminary result.
3. It is possible some substances in certain food and drug that may affect test results.
4. A preliminary result does not mean the frequency or time of drug use, nor does it distinguish between drugs and certain foods and/or medications.

MAILING A SAMPLE TO THE LABORATORY FOR CONFIRMATION TESTING

1. Ensure that the Labeled cup is tightly closed.
2. Be sure to write your contact info on the mailing box that the laboratory can send you the message with the confirmed results along with the Personal Identification Number.
3. Place the Labeled cup in the plastic bag and seal the plastic bag.
4. Place the sealed plastic bag in the mailing box. Close the mailing box and secure it with packing tape. The mailing address for the laboratory is already on the mailing box.
Please note that the mailing box isn't pre-paid. You must attach the proper postage to have a carrier service deliver it. You must also pay for the confirmation testing.

【ADDITIONAL INFORMATION AND REFERENCES】

The following list of organizations may be helpful to you for counseling support and resources. These groups also have an Internet address which can be accessed for additional information.

National Clearinghouse for Alcohol and Drug Information www.health.org
1-800-729-6686

Center for Substance Abuse Treatment www.health.org 1-800-662-HELP

The National Council on Alcoholism and Drug Dependence www.ncadd.org
1-800-NCA-CALL

American Council for Drug Education (ACDE) www.acde.org 1-800-488-DRUG

Manufactured By:

Hangzhou AllTest Biotech Co., Ltd.

#550, Yin Hai Street

Hangzhou Economic & Technological Development Area

Hangzhou, 310018, P. R. China

Web: www.alltests.com.cn Email: info@alltests.com.cn

Customer Service Hotline: 1-888-255-0025

Mon-Fri 9 AM – 5 PM CST

Number: 14602922301

Revision date: 2025-07-07